



Alexander Hudson Estates

Sales Particulars



The Property

Alexander Hudson Estates are please to welcome to the market this 2 bedroom first floor flat, well positioned in the popular Sunholme Estate in Wallsend NE28.

The Property offers well presented and spacious accommodation which comprises; Lounge to front, modern fitted kitchen including integrated appliances. two generous bedrooms both with fitted wardrobes and a bathroom/wc. Externally there is a pleasant enclosed lawned garden to the rear.

Situated just 4 miles east of Newcastle upon Tyne, Wallsend is a vibrant and historically rich town that offers an excellent blend of urban convenience and community charm. Known for its Roman heritage, most notably as the eastern terminus of Hadrian's Wall. Wallsend combines fascinating history with modern day amenities, making it a desirable location for families, professionals, and investors alike. The town boasts a range of local shops, supermarkets, cafes, and restaurants, alongside excellent leisure facilities and green spaces such as Richardson Dees Park and the scenic Wagonways. Wallsend's regenerated town centre and Forum Shopping Centre provide convenient access to everyday essentials. For families, the area is well-served by a selection of primary and secondary schools, while strong transport links make commuting easy. Wallsend Metro Station offers frequent services to Newcastle city centre and the coast, while nearby road links via the A1058 Coast Road and A19 connect to surrounding areas with ease.

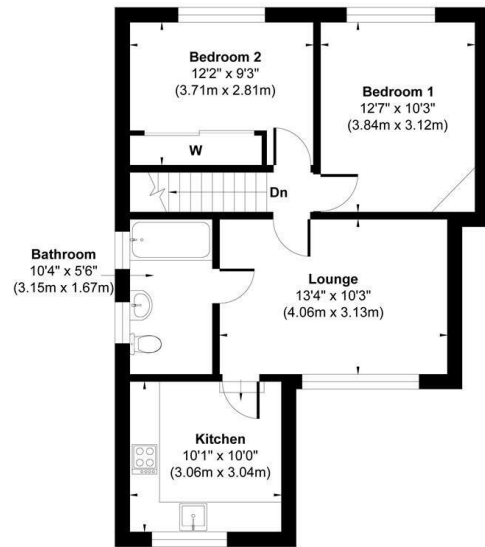

First Floor Flat
Approximate Floor Area
620 sq.ft
(57.60 sq.m)

Approx. Gross Internal Floor Area 620 sq. ft / 57.60 sq. m

Illustration for identification purpose only, measurements approximate and not to scale, unauthorized reproduction is prohibited. All rights reserved for Alexander Hudson Estates

Leasehold
Council Tax: A
EPC Rating: 73

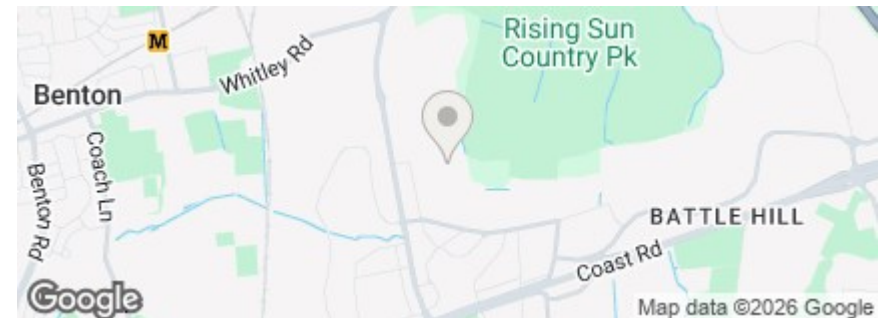



Alexander Hudson Estates
The Printworks
20 Arrow Close
NE12 6QN

0191 268 7433
sales@alexanderhudson.co.uk